

General Description

KR Electronics part number 3428-0256+ is a 1000 MHz Bandpass filter. The filter has a minimum 2 dB bandwidth of 500 MHz. Other center frequencies and bandwidths are available. Please consult the factory.

Features

- 1000 MHz Bandpass Filter
- Selective Elliptic Type Filter
- 3 dB Bandwidth: 500 MHz min
- 40 dB Bandwidth: 660 MHz max
- 50 Ω Source and Load
- Surface Mount
- Available with SMA Connectors

Typical Performance

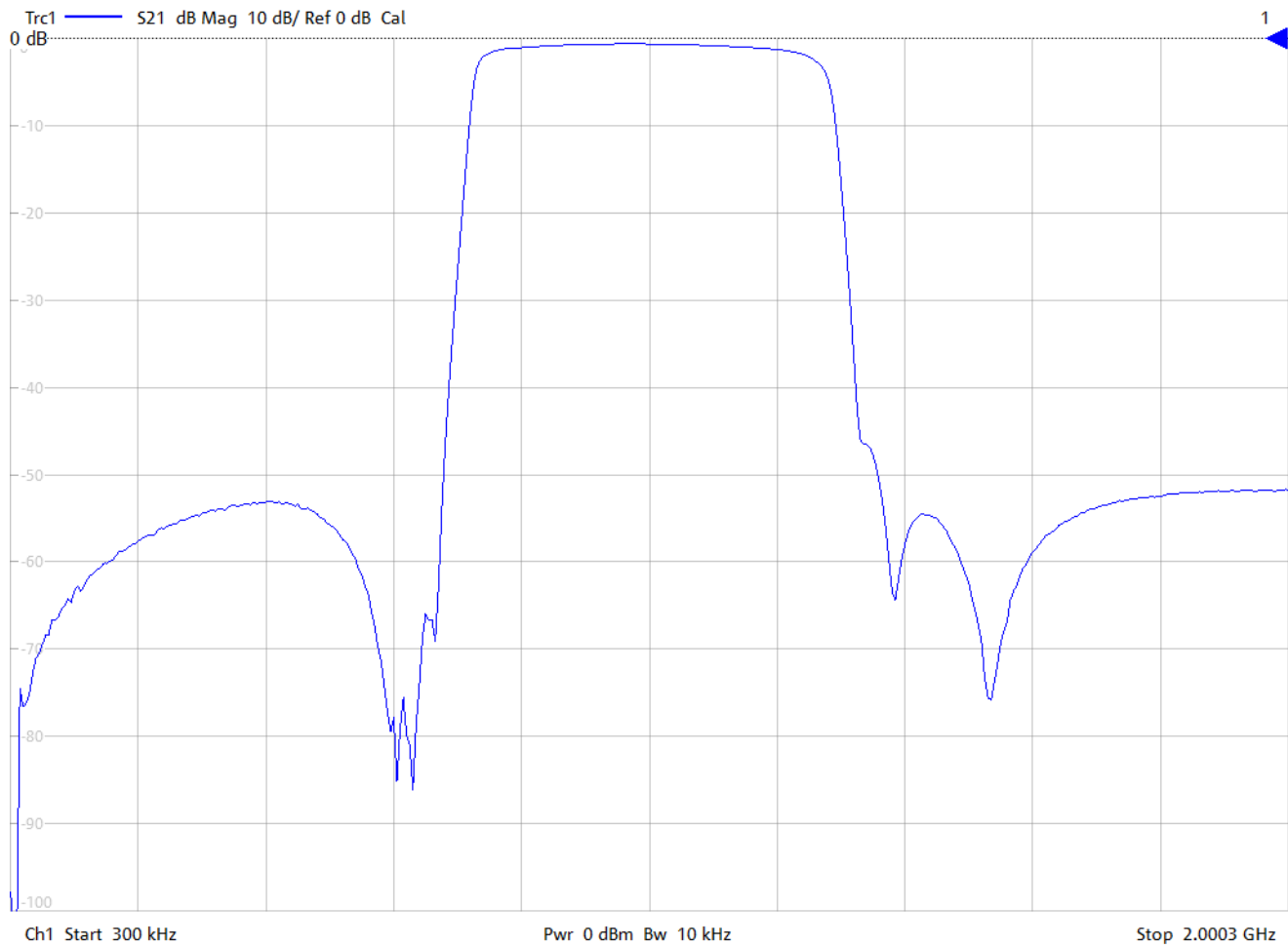

KR Electronics 3428-0256+

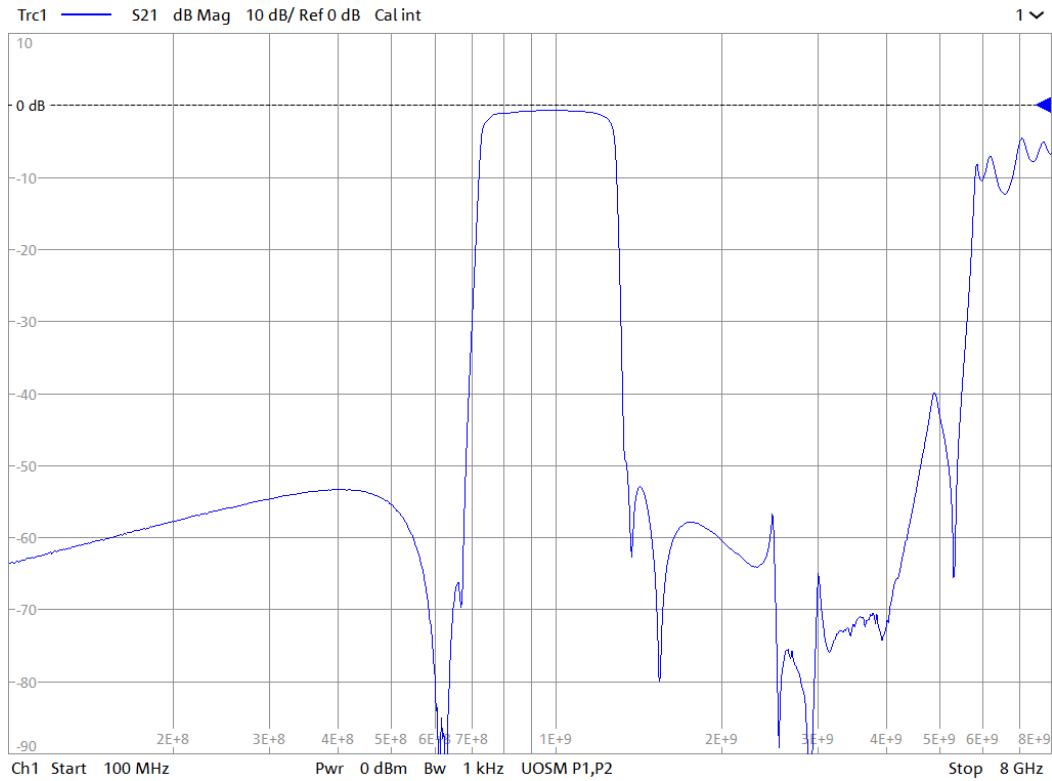
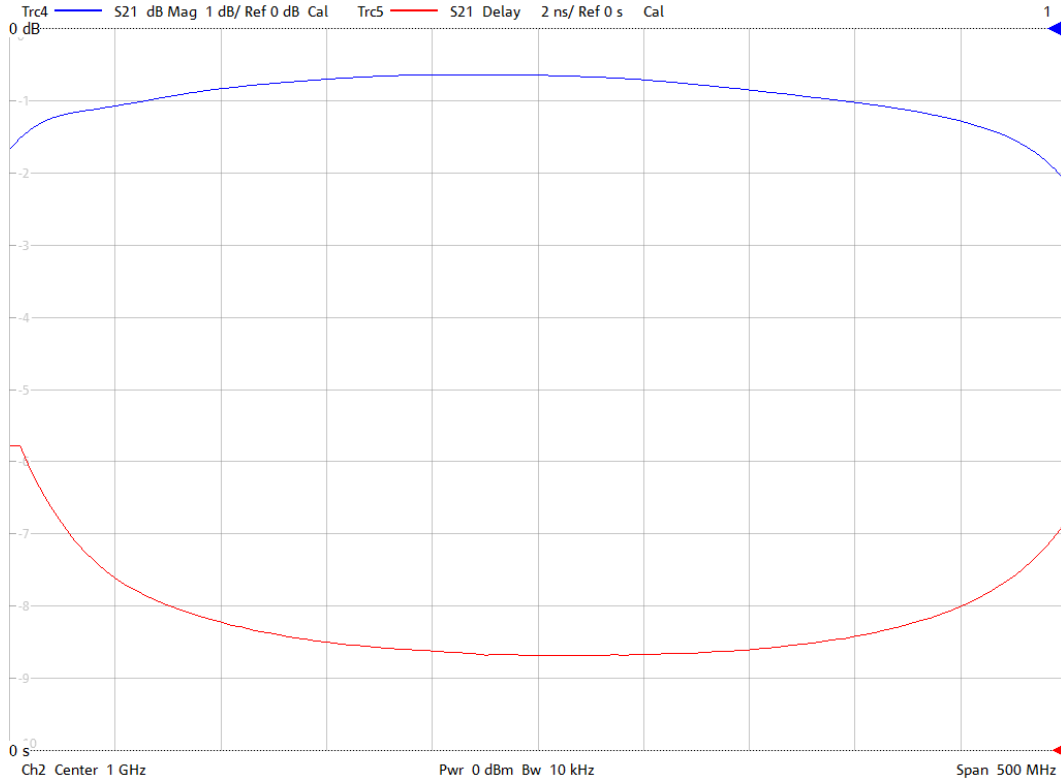

KR Electronics, Inc.
91 Avenel Street
Avenel, NJ 07001

Web www.krfilters.com
Email sales@krfilters.com
Phone (732) 636-1900

KR Electronics 3428-0256+

Specifications

Parameter	Specification	Notes
Filter type	Bandpass	
Center Frequency	1000 MHz	
Insertion Loss at Fc	1.25 dBa max	0.7 dBa typical
1 dBc Bandwidth	480 MHz typical	
2 dBc Bandwidth	500 MHz min	
40 dBc Bandwidth	660 MHz max	to 4000 MHz
Source and Load	50 Ω	

Physical Dimensions

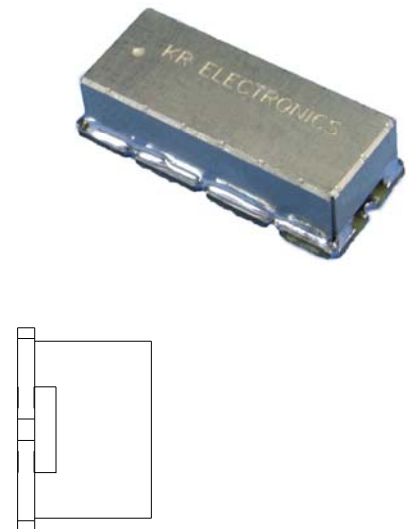
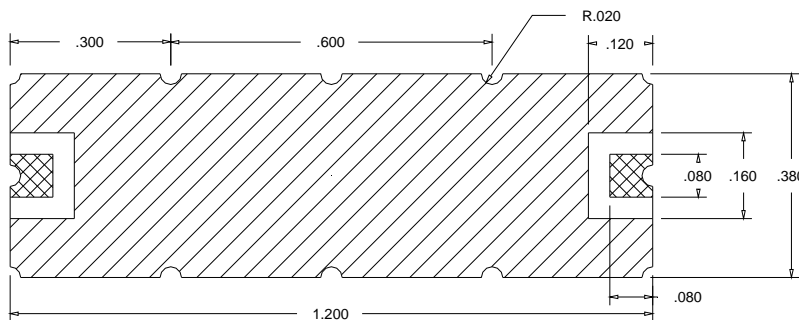
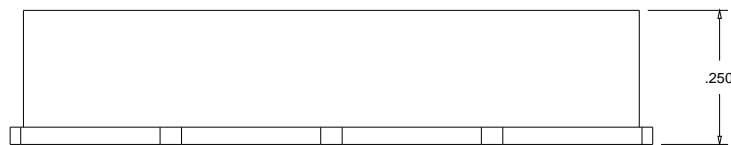

Notes:

1. Surface mount package
2. Dimensions in inches
3. Max reflow temperature 230° C for 10 sec
4. If boards are cleaned after installation units must be completely dried

KR Electronics, Inc.
91 Avenel Street
Avenel, NJ 07001

Web www.krfilters.com
Email sales@krfilters.com
Phone (732) 636-1900
Fax (732) 636-1982