

## General Description

KR Electronics part number 3428-0237+ is a 1000 MHz Bandpass filter. The filter has a minimum 3 dB bandwidth of 160 MHz. Other center frequencies and bandwidths are available. Please consult the factory.

## Features

- 1000 MHz Bandpass Filter
- Selective Elliptic Type Filter
- 3 dB Bandwidth: 160 MHz min
- 45 dB Bandwidth: 400 MHz max
- 50  $\Omega$  Source and Load
- Surface Mount
- Available with SMA Connectors

## Typical Performance

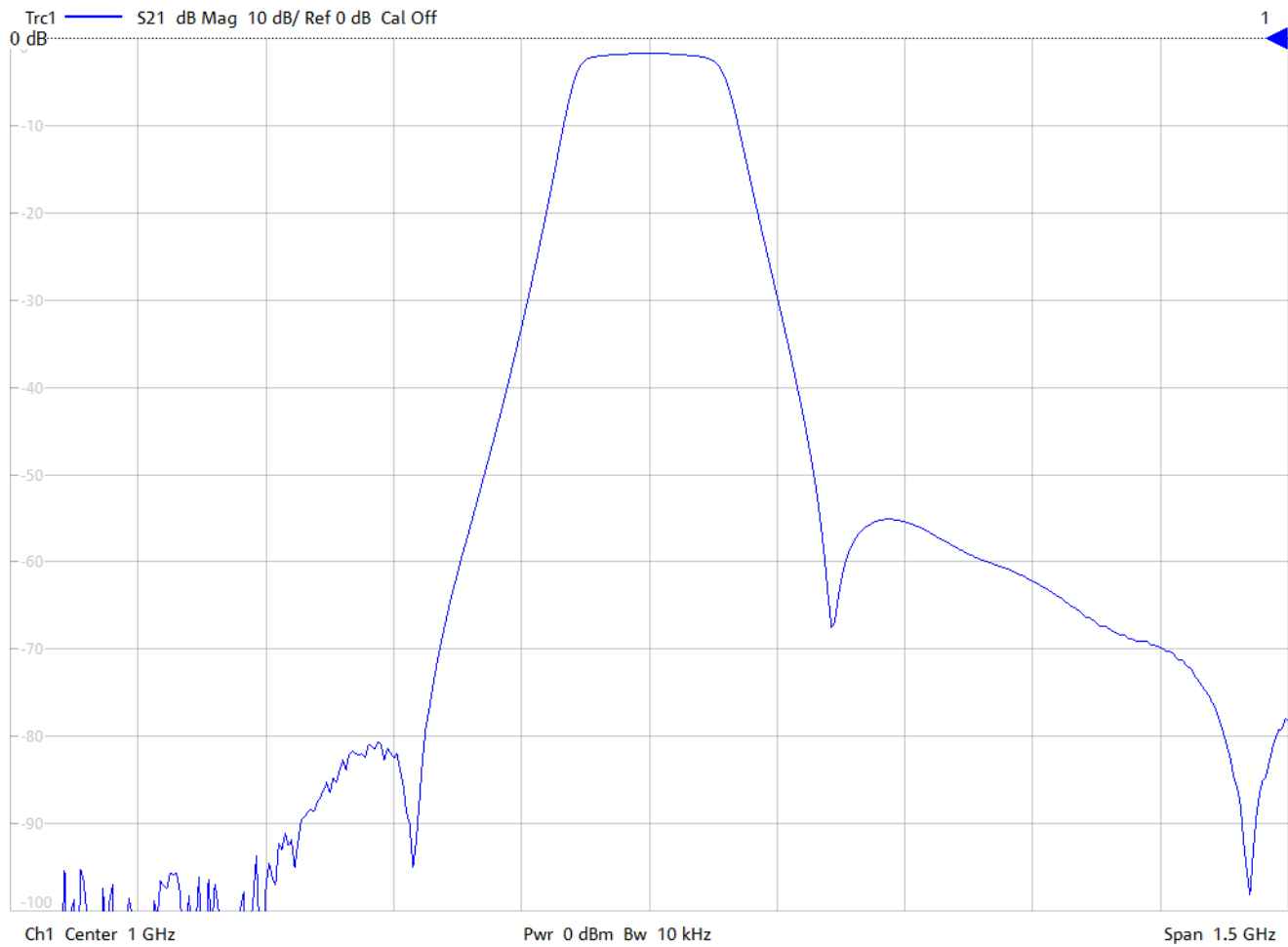

# KR Electronics 3428-0237+

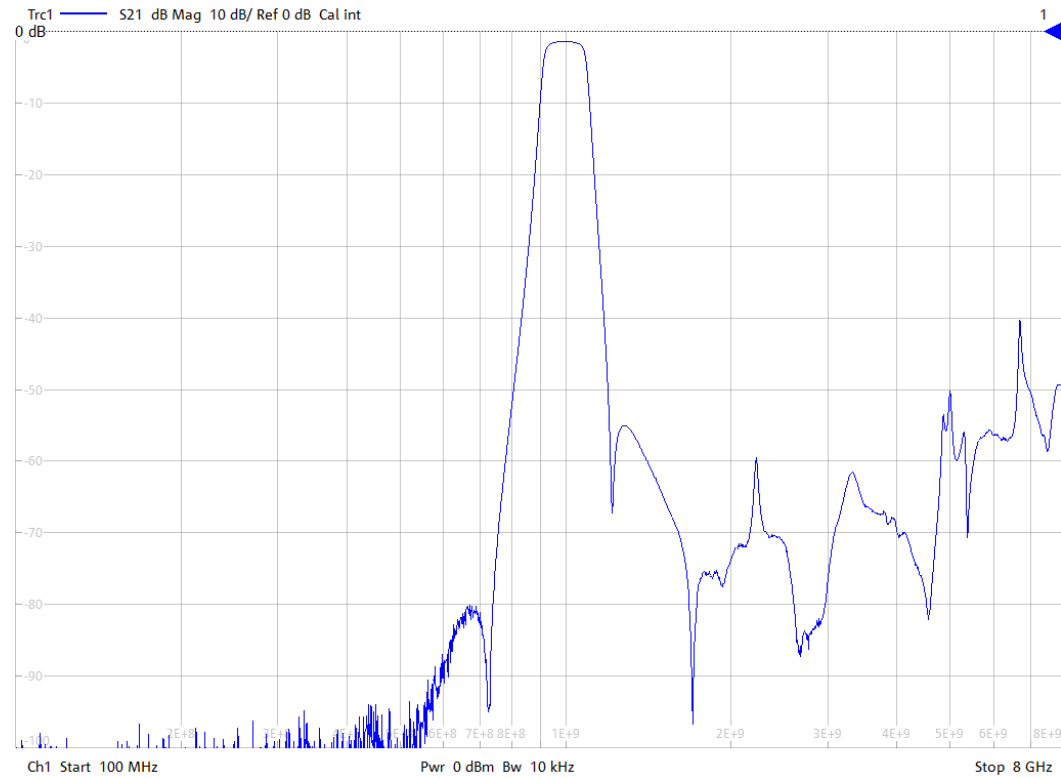
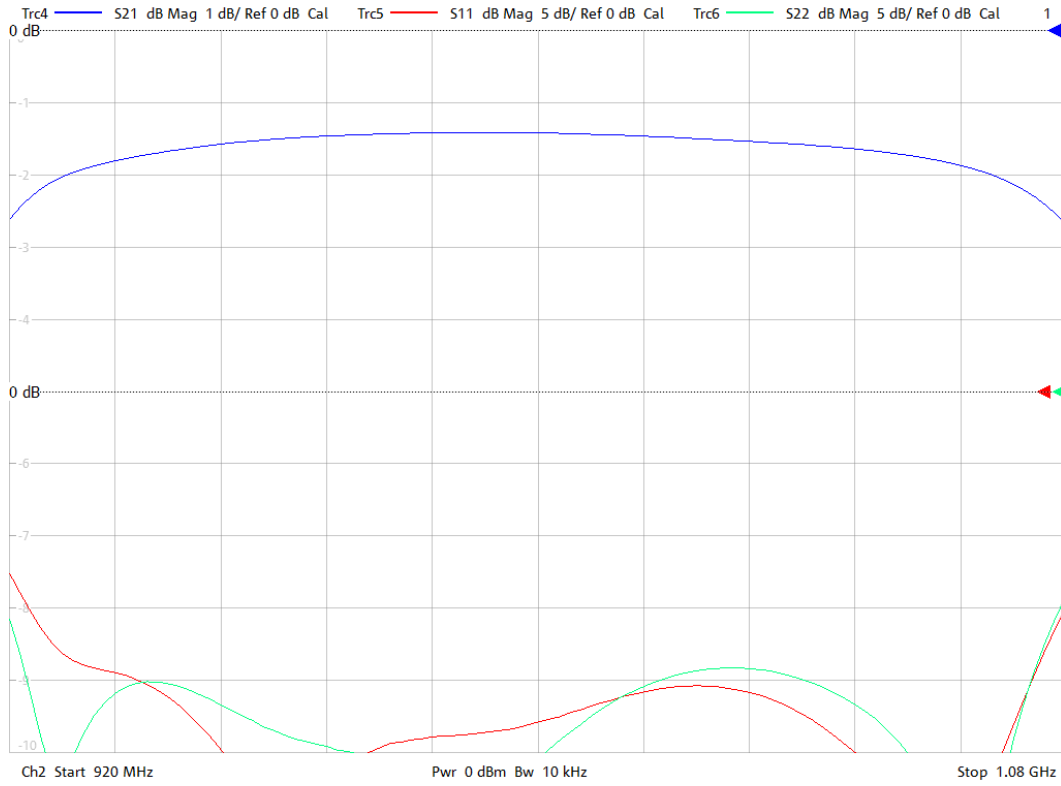

KR Electronics, Inc.  
91 Avenel Street  
Avenel, NJ 07001

Web        www.krfilters.com  
Email     sales@krfilters.com  
Phone     (732) 636-1900

# KR Electronics 3428-0237+

## Specifications

Parameter	Specification	Notes
Filter type	Bandpass	
Center Frequency	1000 MHz	
Insertion Loss at Fc	2.25 dBa max	1.45 dBa typical
1 dBc Bandwidth	154 MHz typical	
3 dBc Bandwidth	160 MHz min	
45 dBc Bandwidth	800 MHz max	to 5000 MHz
Source and Load	50 $\Omega$	

## Physical Dimensions

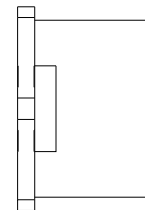
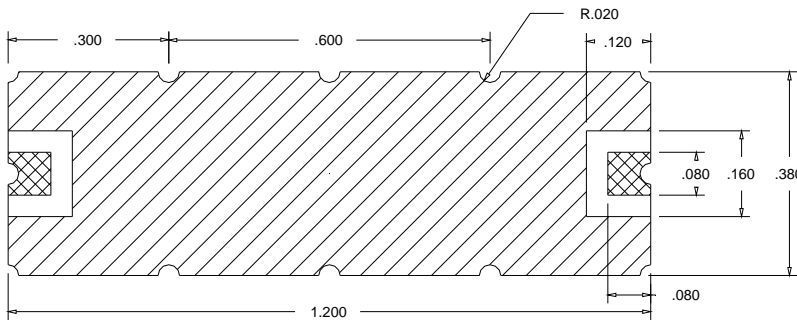
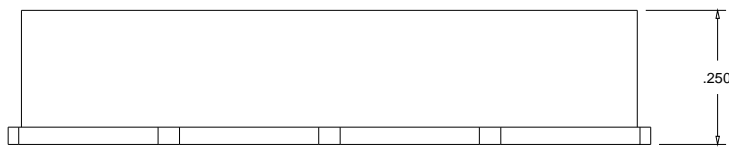

**Notes:**

1. Surface mount package
2. Dimensions in inches
3. Max reflow temperature 230° C for 10 sec
4. If boards are cleaned after installation units must be completely dried

KR Electronics, Inc.  
 91 Avenel Street  
 Avenel, NJ 07001

Web [www.krfilters.com](http://www.krfilters.com)  
 Email [sales@krfilters.com](mailto:sales@krfilters.com)  
 Phone (732) 636-1900  
 Fax (732) 636-1982