

General Description

KR Electronics part number 3415-1792 is a 1792 MHz Bandpass filter. The filter has a typical 3 dB bandwidth of 1147 MHz. Other center frequencies and bandwidths are available. Please consult the factory.

Features

- 1792 MHz Bandpass Filter
- Selective Elliptic Type Filter
- 3 dB Bandwidth: 1147 MHz typical
- 50 dB Bandwidth: 1877 MHz typical
- 50 Ω Source and Load
- Surface Mount

Typical Performance

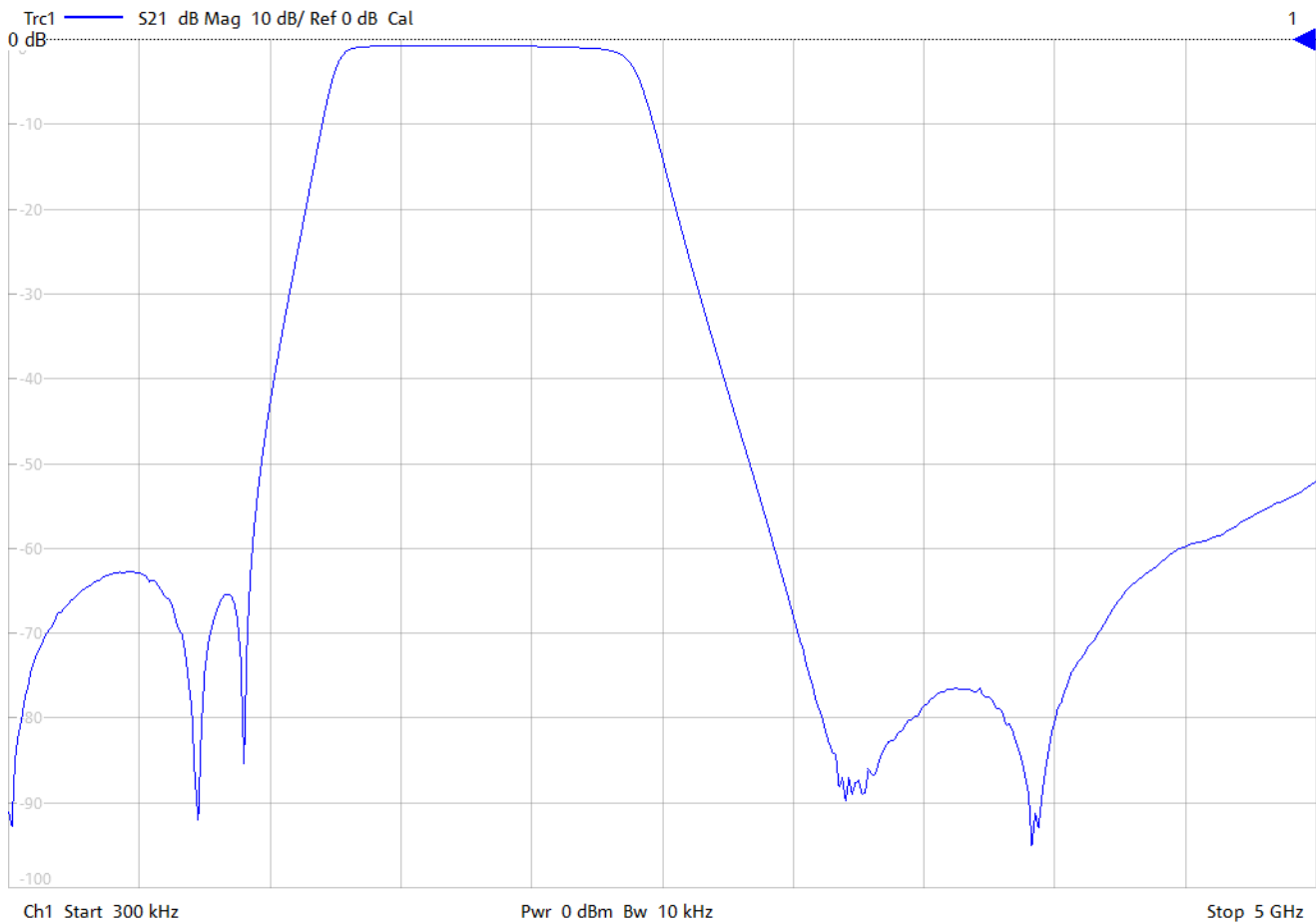

KR Electronics 3415-1792

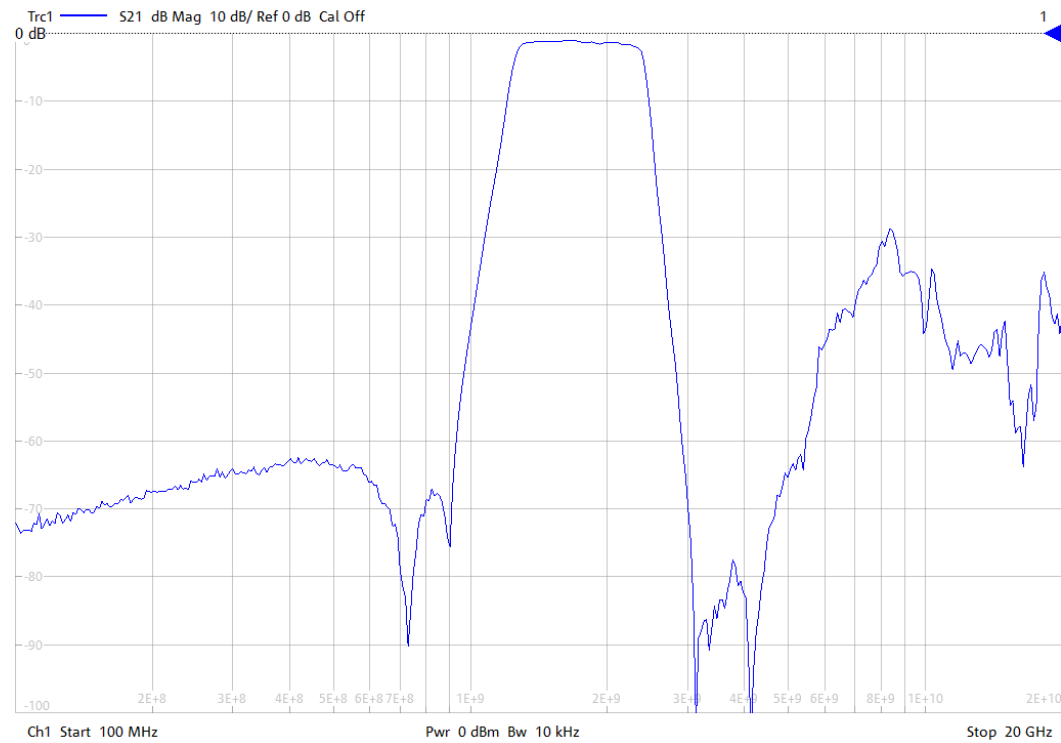
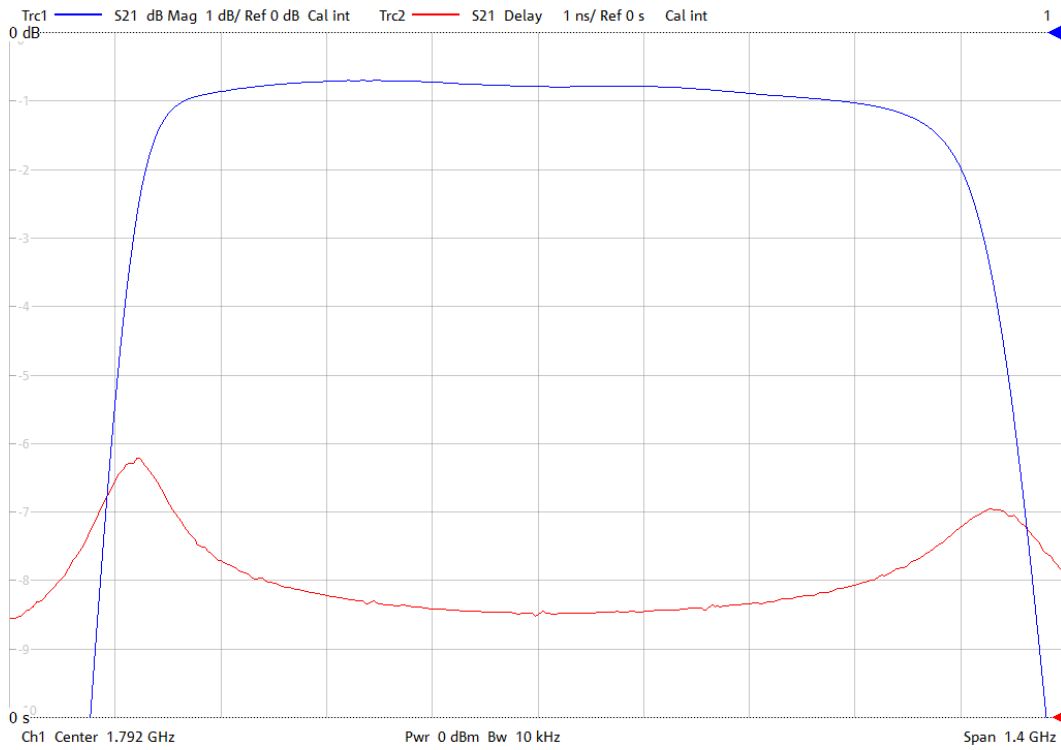

KR Electronics, Inc.
 91 Avenel Street
 Avenel, NJ 07001

Web www.krfilters.com
 Email sales@krfilters.com
 Phone (732) 636-1900
 Fax (732) 636-1982

KR Electronics 3415-1792

Specifications

Parameter	Specification	Notes
Filter type	Bandpass	
Center Frequency	1792 MHz	
Insertion Loss at Fc	1 dBa max	0.7 dBa typical
1 dBc Bandwidth	1057 MHz typical	
3 dBc Bandwidth	1147 MHz typical	
50 dBc Bandwidth	1877 MHz typical	
50 dBc min rejection to	5 GHz	Stopband can be extended by adding grounding to top of case
Source and Load	50 Ω	

Physical Dimensions

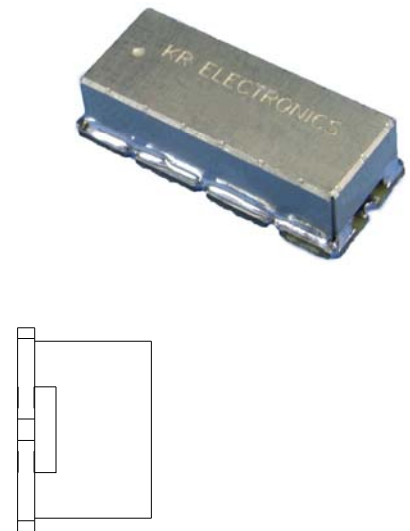
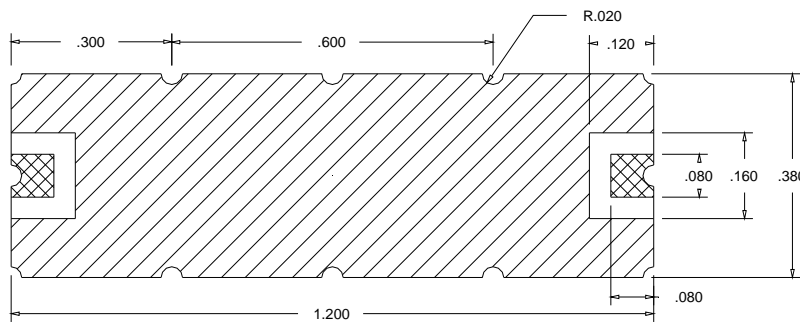
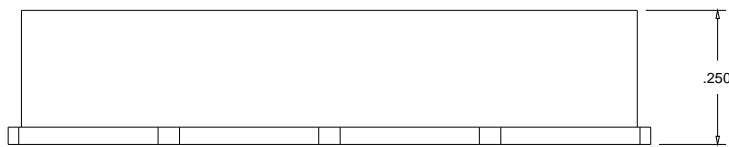

Notes:

1. Surface mount package
2. Dimensions in inches
3. Max reflow temperature 230° C for 10 sec
4. If boards are cleaned after installation units must be completely dried