

KR Electronics, Inc.

General Description

KR Electronics part number 3411+ is a 1510 MHz Bandpass filter. The filter has a minimum 2 dB bandwidth of 420 MHz. Other center frequencies and bandwidths are available. Please consult the factory.

Features

- 1510 MHz Bandpass Filter
- Selective Elliptic Type Filter
- 3 dB Bandwidth: 530 MHz typical
- 50 dB Bandwidth: 670 MHz typical
- 50 Ω Source and Load
- Surface Mount

Typical Performance

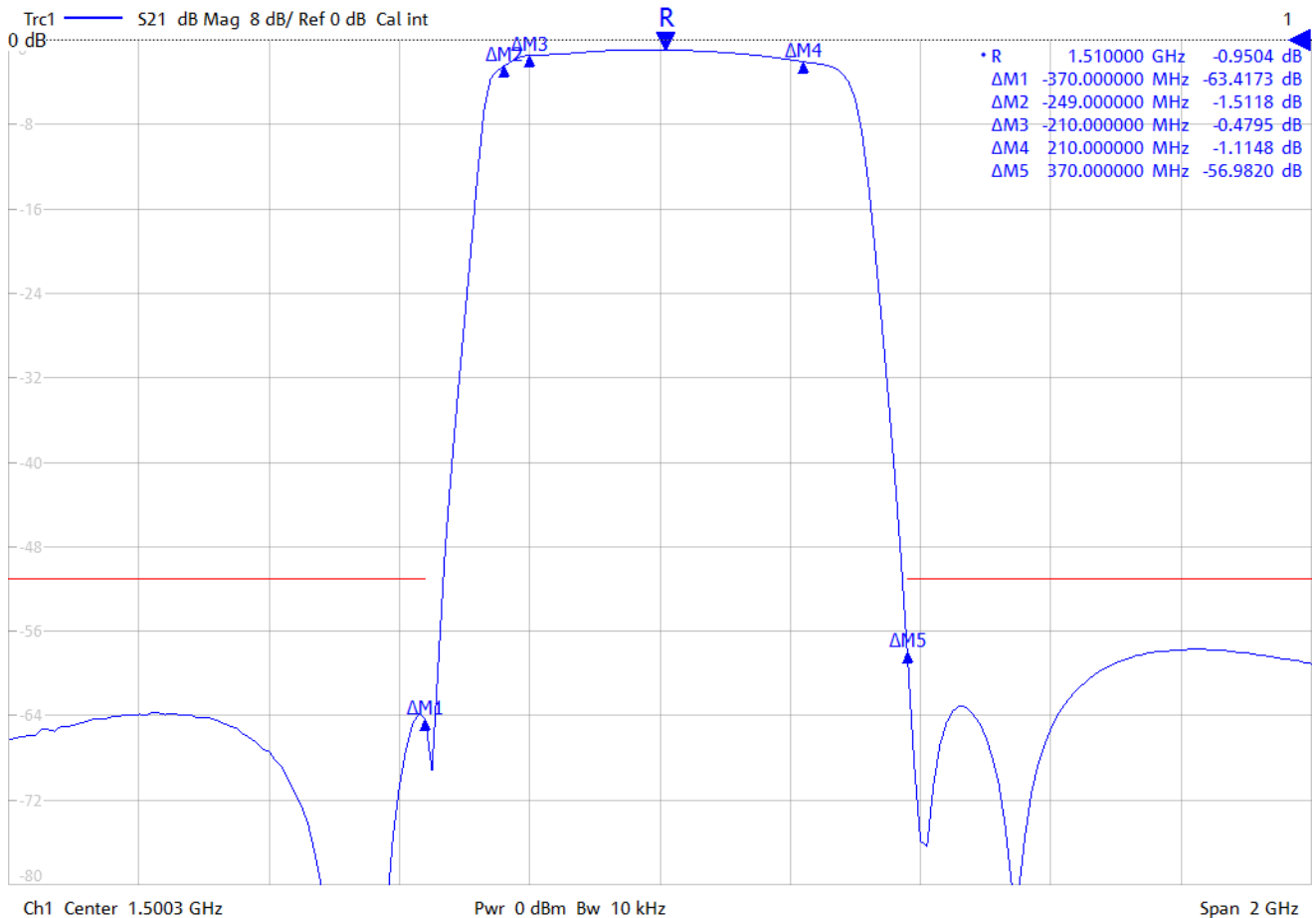

KR Electronics 3411+

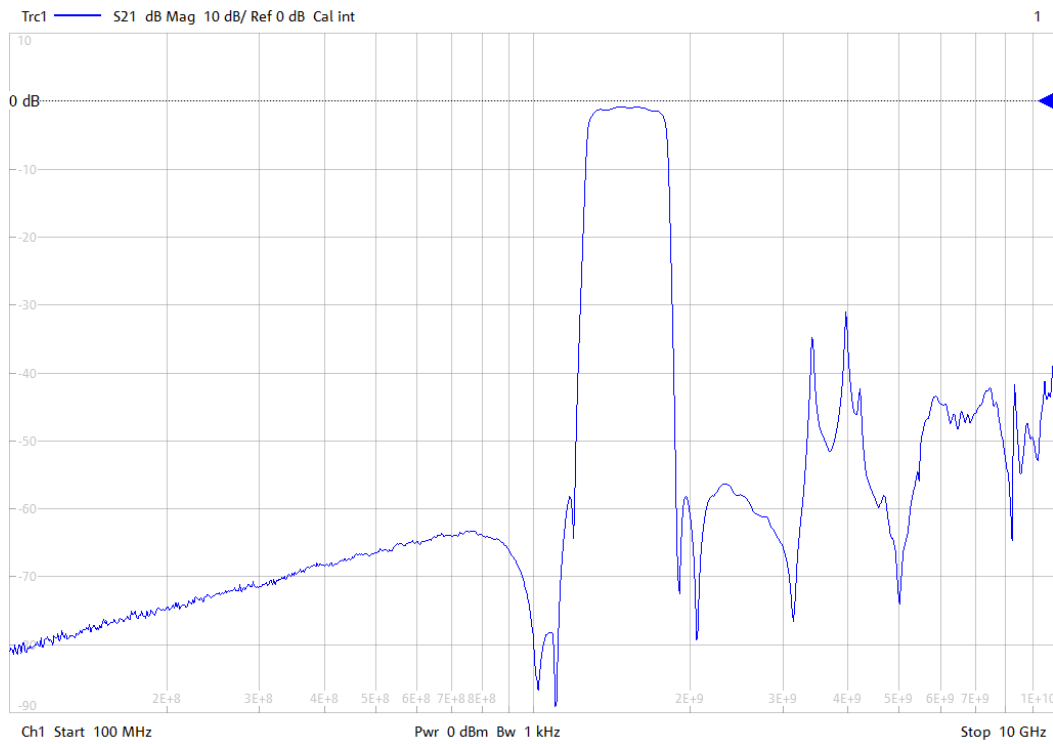
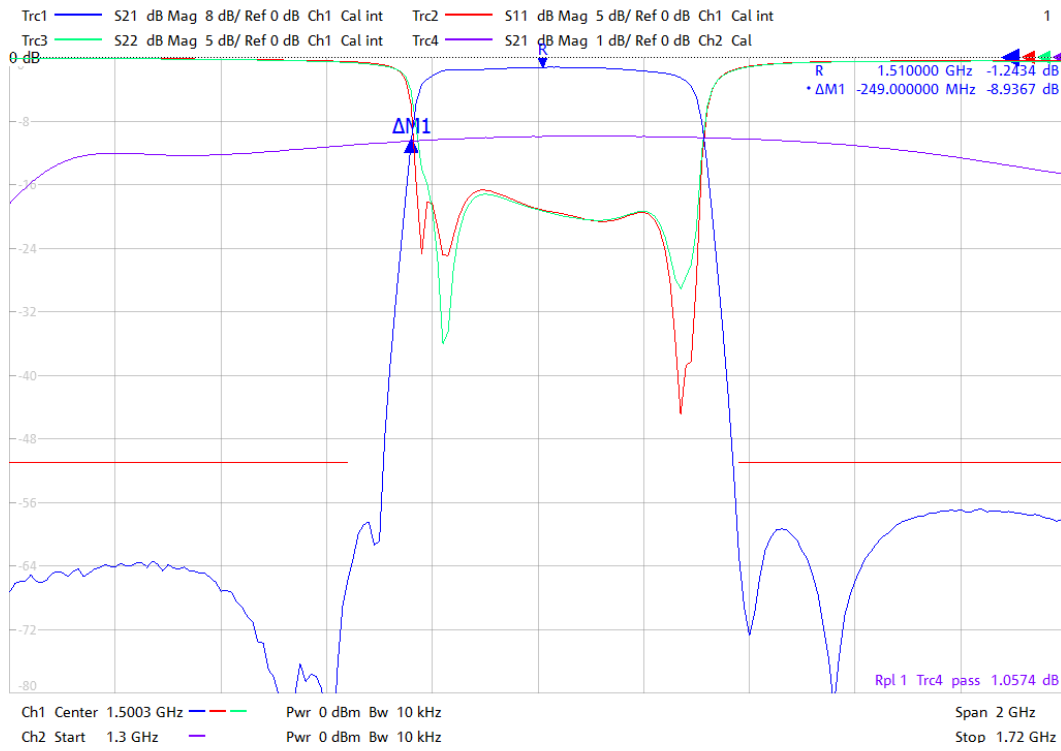

KR Electronics, Inc.
 91 Avenel Street
 Avenel, NJ 07001

Web www.krfilters.com
 Email sales@krfilters.com
 Phone (732) 636-1900
 Fax (732) 636-1982

KR Electronics 3411+

Specifications

Parameter	Specification	Notes
Filter type	Bandpass	
Center Frequency	1510 MHz	
Insertion Loss at Fc	2 dBa max	1.25 dBa typical
2 dBc Bandwidth	420 MHz min	510 MHz typical
3 dBc Bandwidth	530 MHz typical	
50 dBc Bandwidth	740 MHz max	670 MHz typical
50 dBc min rejection to	3 GHz	
Source and Load	50 Ω	

Physical Dimensions

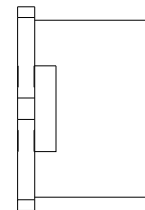
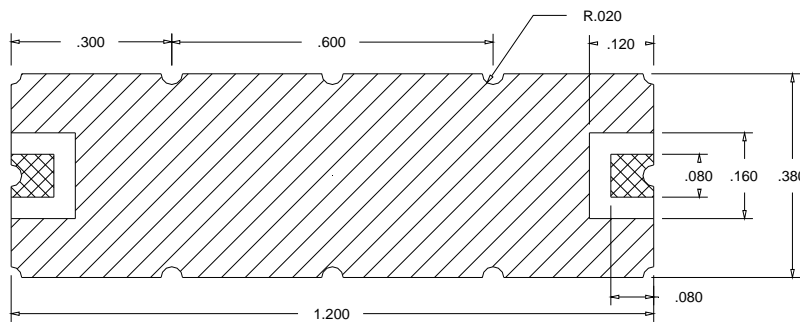
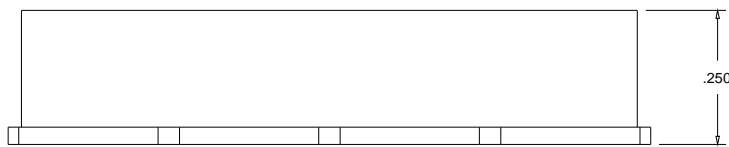

Notes:

1. Surface mount package
2. Dimensions in inches
3. Max reflow temperature 230° C for 10 sec
4. If boards are cleaned after installation units must be completely dried