

## General Description

KR Electronics part number 3389 is a 750 MHz bandpass filter. Other frequencies are available. Please consult the factory.

## Features

- 750 MHz Bandpass Filter
- 1 dB Bandwidth 223 MHz typical
- 85 dB min at 500 & 1000 MHz
- Sharp Elliptic Type Filter
- 50  $\Omega$  Source and Load
- Surface Mount
- Other frequencies available

## Typical Performance

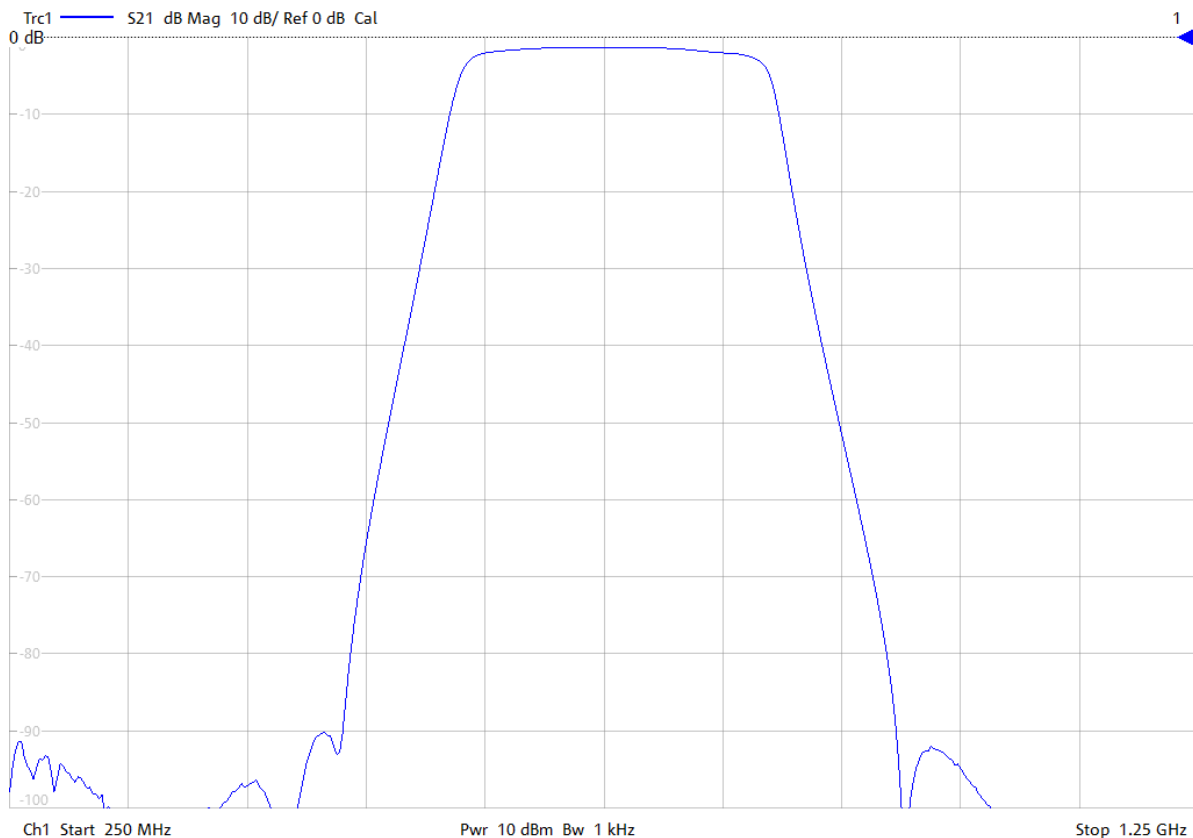

KR Electronics, Inc.  
91 Avenel Street  
Avenel, NJ 07001

Web [www.krfilters.com](http://www.krfilters.com)  
Email [sales@krfilters.com](mailto:sales@krfilters.com)  
Phone (732) 636-1900  
Fax (732) 636-1982

# KR Electronics 3389

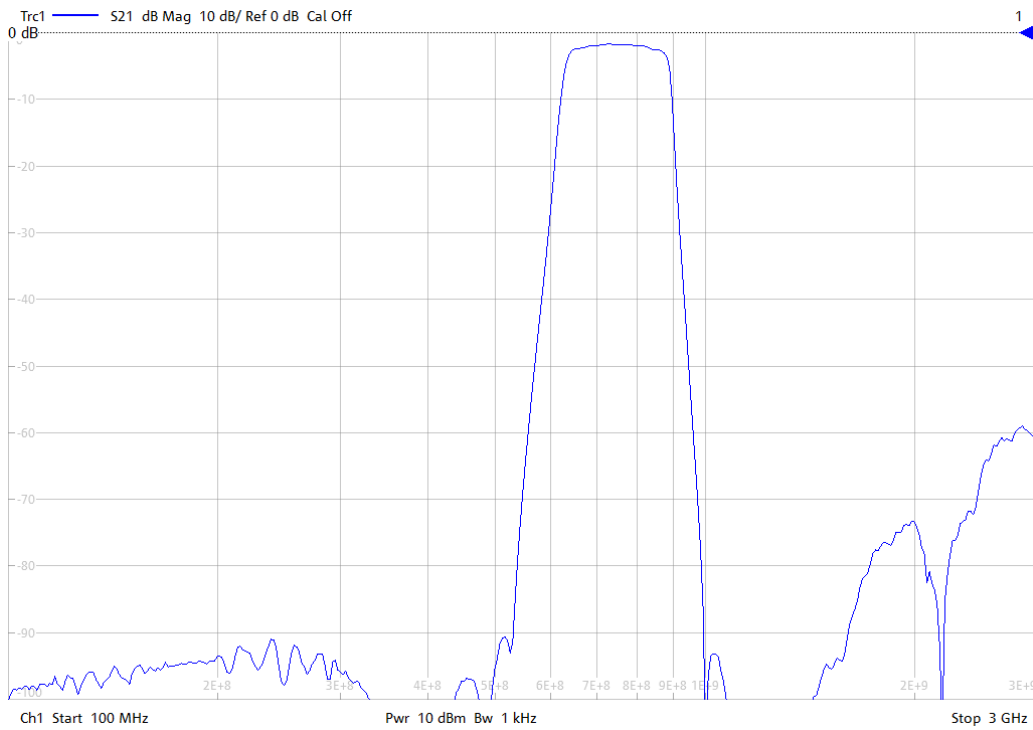
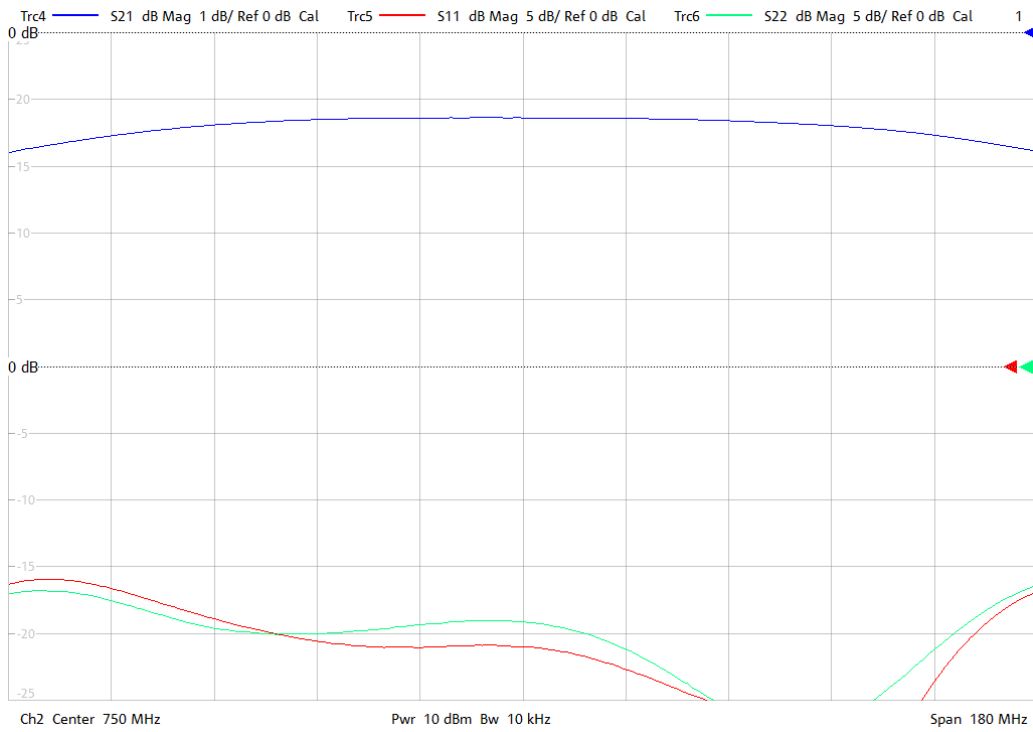

KR Electronics, Inc.  
91 Avenel Street  
Avenel, NJ 07001

Web [www.krfilters.com](http://www.krfilters.com)  
Email [sales@krfilters.com](mailto:sales@krfilters.com)  
Phone (732) 636-1900  
Fax (732) 636-1982

# KR Electronics 3389

## Specifications

Parameter	Specification	
Filter type	Bandpass	
Center Frequency (Fc)	750 MHz	
Insertion Loss at Fc	3 dBa max	1.3 dBa typical
1 dBc Bandwidth	180 MHz min	220 MHz typical
Rejection DC to 500 MHz	85 dBc min	
Rejection 1000 to 1500 MHz	85 dBc min	
Source and Load	50 $\Omega$	

## Physical Dimensions

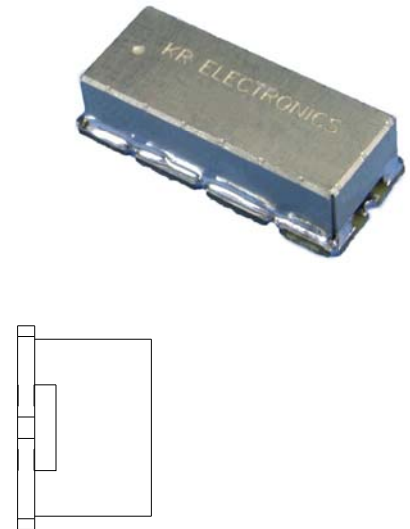
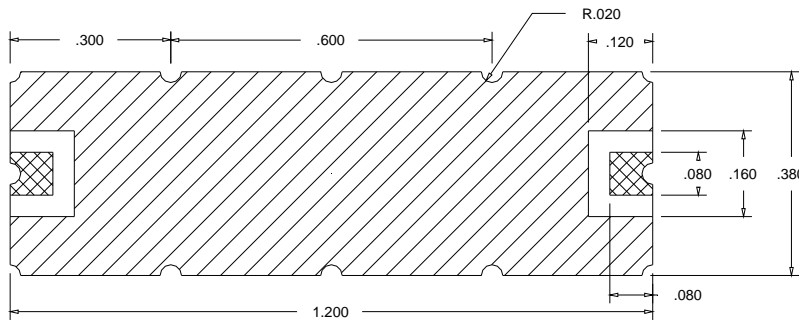
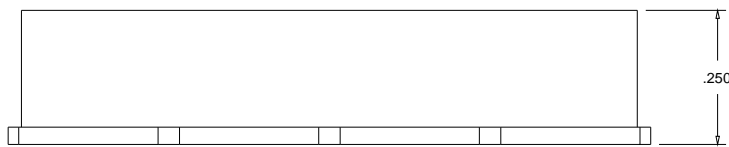

**Notes:**

1. Surface mount package
2. Dimensions in inches
3. Max reflow temperature 230° C for 10 sec
4. If boards are cleaned after installation units must be completely dried

KR Electronics, Inc.  
91 Avenel Street  
Avenel, NJ 07001

Web [www.krfilters.com](http://www.krfilters.com)  
Email [sales@krfilters.com](mailto:sales@krfilters.com)  
Phone (732) 636-1900  
Fax (732) 636-1982