

General Description

KR Electronics part number 3174A-21.4-0.4 is a 21.4 MHz bandpass filter. The filter has a 3 dB bandwidth of 400 KHz. Other center frequencies and bandwidths are available. Please consult the factory.

Features

- 21.4 MHz Bandpass Filter
- 400 KHz Typical 3 dB Bandwidth
- 50 Ω Source and Load
- Surface Mount
- Also available with SMA Connectors

Typical Performance

Overall Response (10 dB/div)

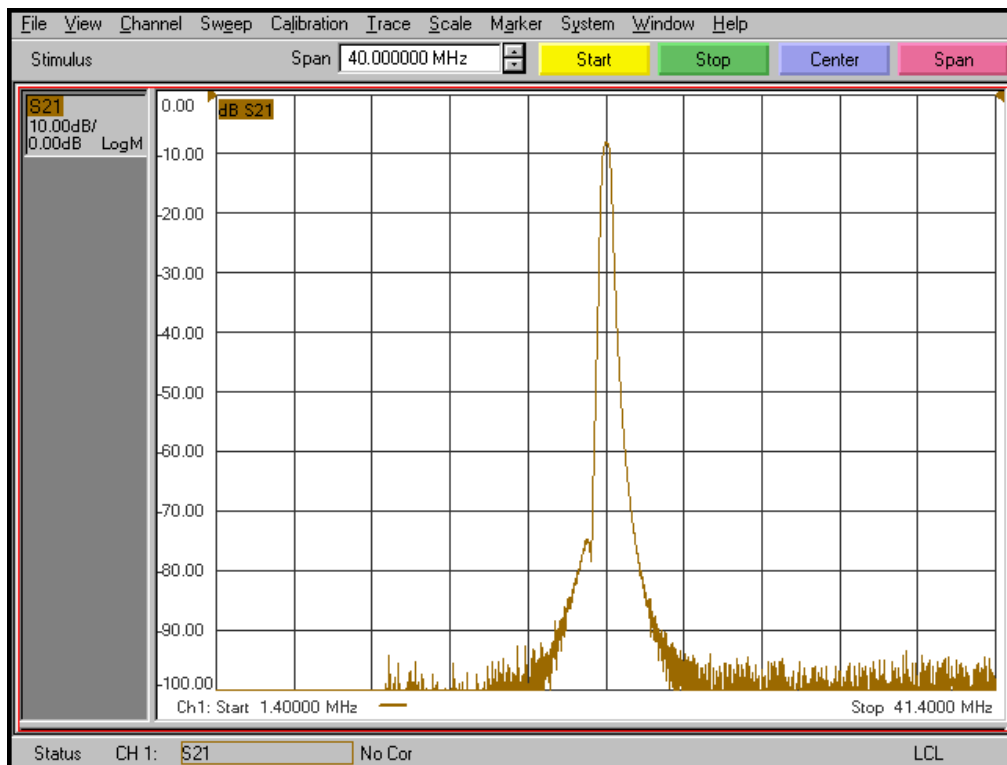

Typical Performance

Passband Amplitude & Group Delay (1 dB/div)

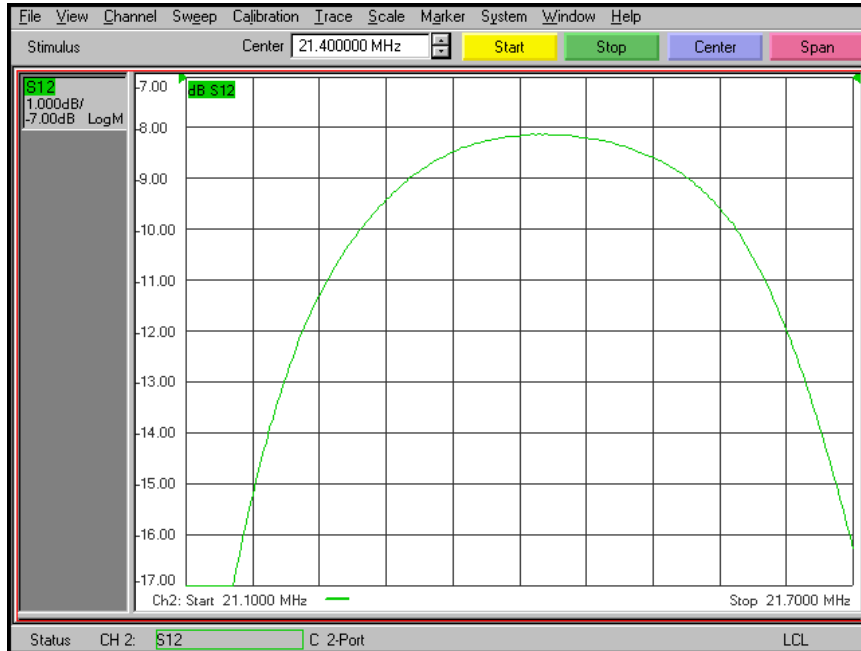

Overall Response (10 dB/div)

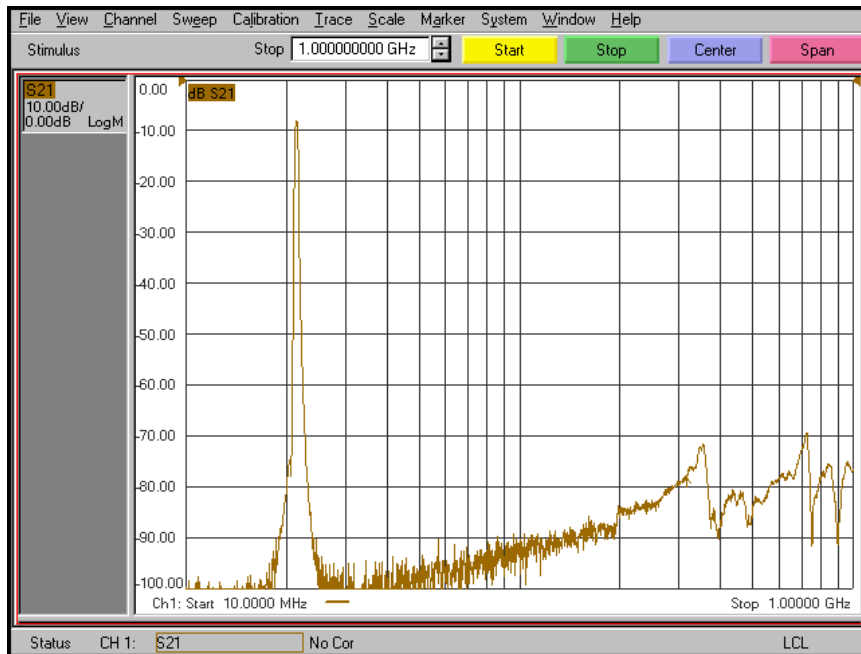

KR Electronics, Inc.
91 Avenel Street
Avenel, NJ 07001

Web www.krfilters.com
Email sales@krfilters.com
Phone (732) 636-1900
Fax (732) 636-1982

KR Electronics 3174A-21.4-0.4

Specifications

Parameter	Specification	Notes
Filter type	Bandpass	
Center Frequency	21.4 MHz \pm 0.25%	
Insertion Loss	10 dBa max	8 dBa typical
3 dBc Bandwidth	400 KHz \pm 10%	
40 dBc Bandwidth	1.25 MHz typical	
60 dBc Bandwidth	1.55 MHz typical	
Source and Load	50 Ω	

Physical Dimensions

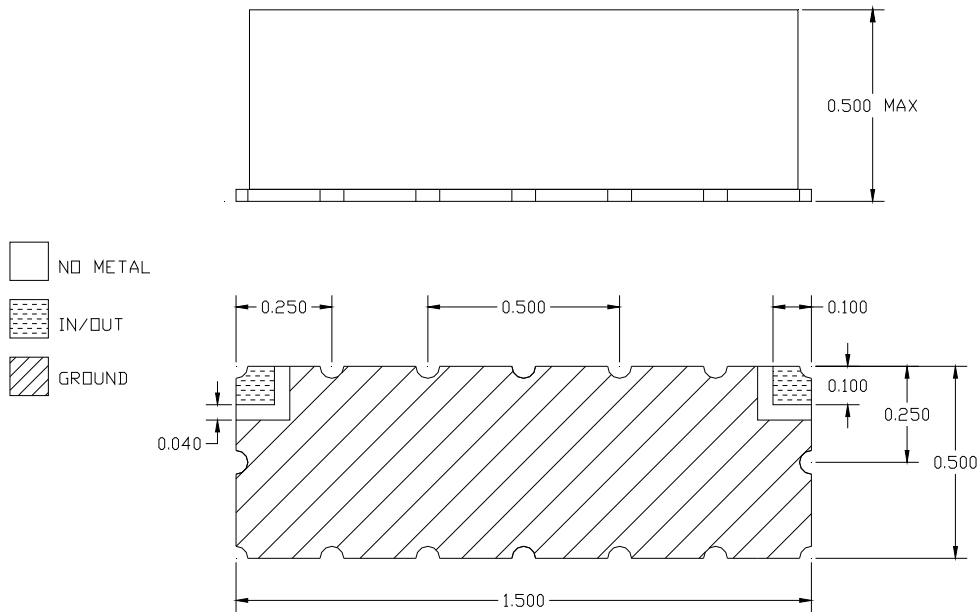

Notes:

1. Surface mount package — Metal cover
2. Dimensions in inches
3. Maximum reflow temperature is 230° C for 10 sec maximum.
4. If boards are cleaned after installation, dry units completely.

KR Electronics, Inc.
91 Avenel Street
Avenel, NJ 07001

Web www.krfilters.com
Email sales@krfilters.com
Phone (732) 636-1900
Fax (732) 636-1982