

# KR Electronics, Inc.

## General Description

KR Electronics part number 3260-1100 is a 1100 MHz bandpass filter. Other frequencies are available. Please consult the factory.

## Features

- 1100 MHz Bandpass Filter
- 2 dB Bandwidth 400 MHz min
- 55 dB min at 780 & 1410 MHz
- Sharp Elliptic Type Filter
- 50  $\Omega$  Source and Load
- Surface Mount
- Other frequencies available

## Typical Performance

**Overall Response**  
(10 dB/div)

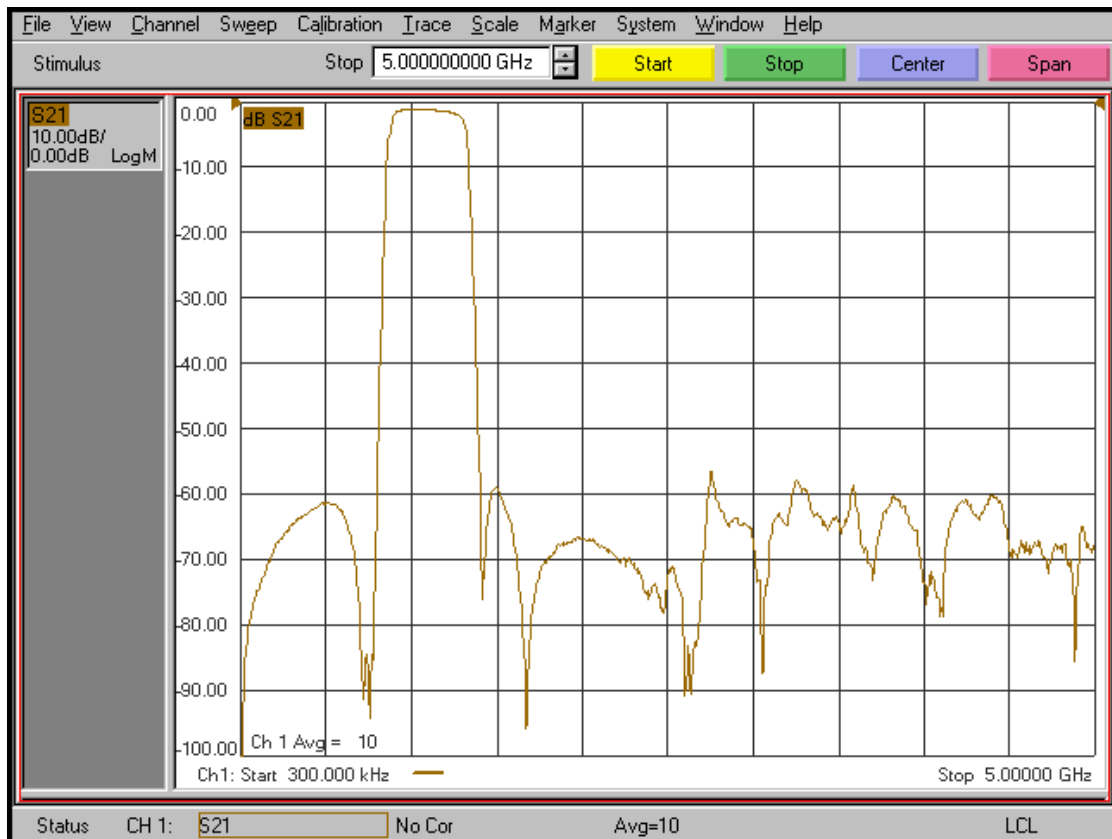

KR Electronics, Inc.  
91 Avenel Street  
Avenel, NJ 07001

Web [www.krfilters.com](http://www.krfilters.com)  
Email [sales@krfilters.com](mailto:sales@krfilters.com)  
Phone (732) 636-1900  
Fax (732) 636-1982

# KR Electronics 3260-1100

## Passband Amplitude & Group Delay (1 dB/div & 2 nsec/div)

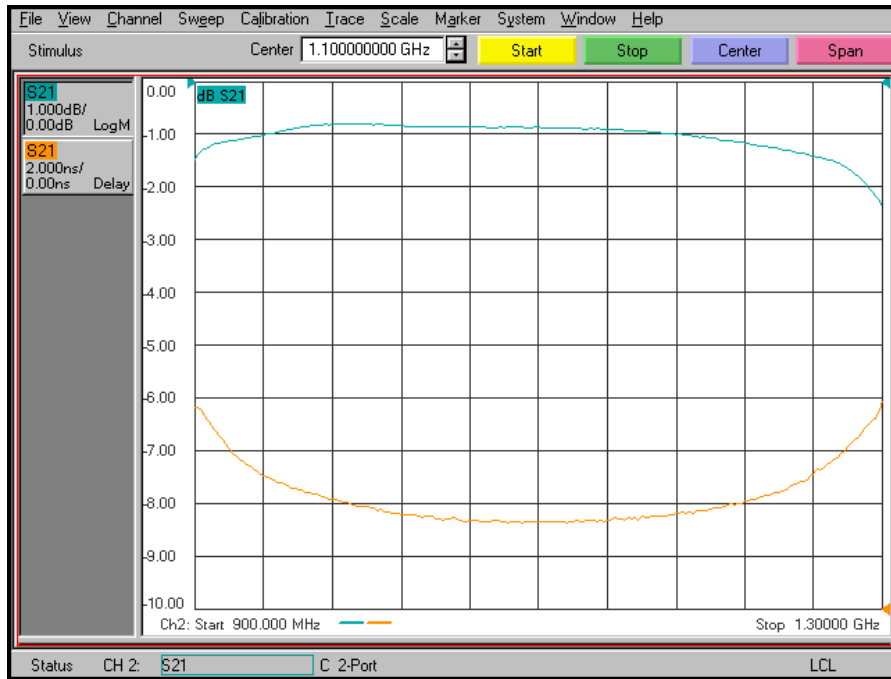

## Overall Response (10 dB/div)

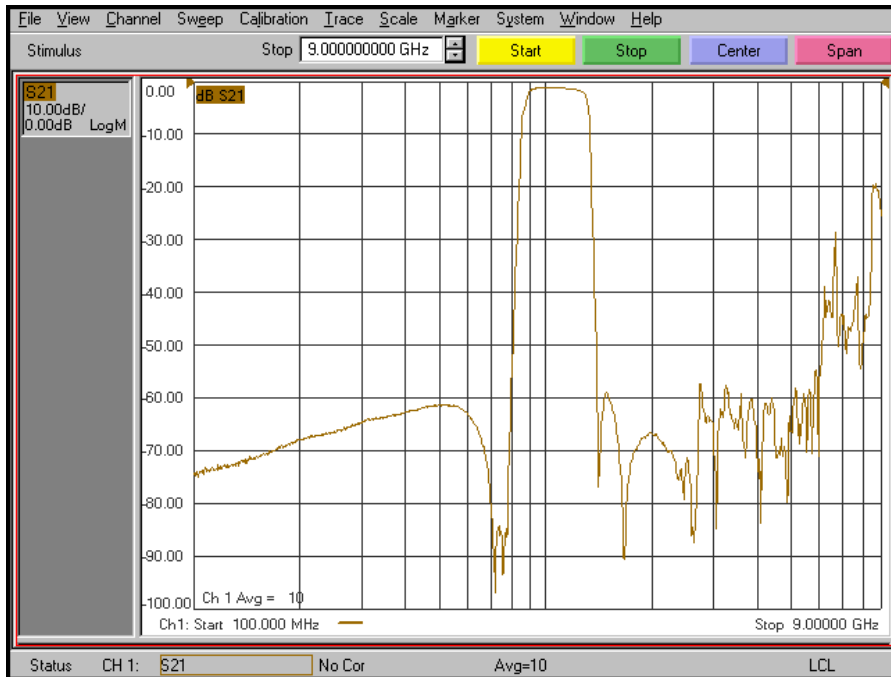

KR Electronics, Inc.  
91 Avenel Street  
Avenel, NJ 07001

Web: [www.krfilters.com](http://www.krfilters.com)  
Email: [sales@krfilters.com](mailto:sales@krfilters.com)  
Phone: (732) 636-1900  
Fax: (732) 636-1982

# KR Electronics 3260-1100

## Specifications

Parameter	Specification	
Filter type	Bandpass	
Center Frequency (Fc)	1100 MHz	
Insertion Loss at Fc	2 dBa max	1 dBa typical
2 dBc Bandwidth	400 MHz min	
Rejection DC to 780 MHz	55 dBc min	
Rejection 1410 to 2000 MHz	55 dBc min	to 5000 MHz typical
Source and Load	50 Ω	

## Physical Dimensions

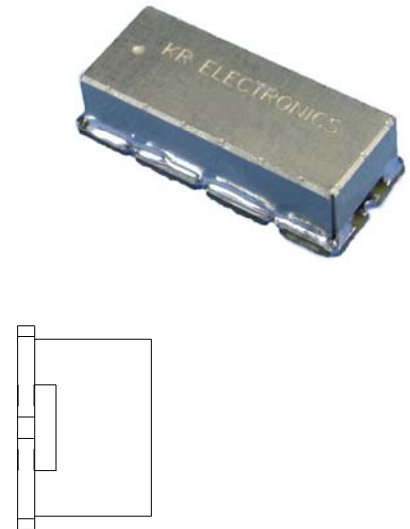
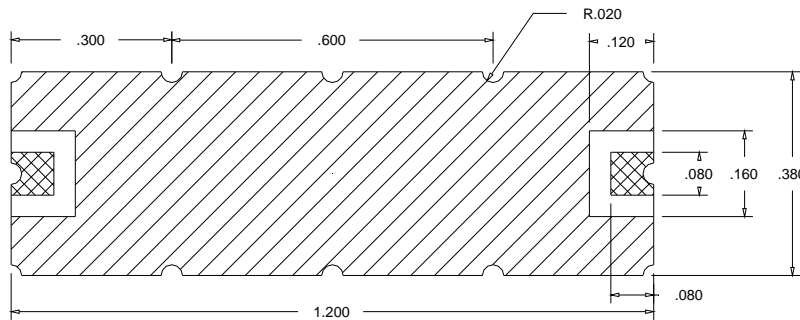
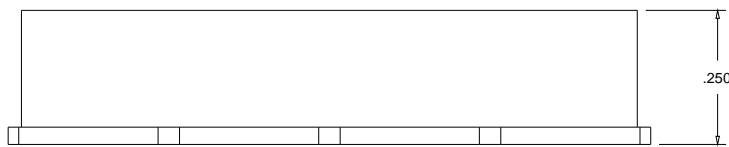

**Notes:**

1. Surface mount package
2. Dimensions in inches
3. Max reflow temperature 230° C for 10 sec
4. If boards are cleaned after installation units must be completely dried

KR Electronics, Inc.  
91 Avenel Street  
Avenel, NJ 07001

Web [www.krfilters.com](http://www.krfilters.com)  
Email [sales@krfilters.com](mailto:sales@krfilters.com)  
Phone (732) 636-1900  
Fax (732) 636-1982