

General Description

KR Electronics part number 3112 is a 300 MHz bandpass filter. The filter has a 315 MHz min 3 dB bandwidth. Other center frequencies and bandwidths are available. Please consult the factory.

Features

- 300 MHz Bandpass Filter
- 315 MHz min 3 dB Bandwidth
- 40 dB min Rejection at 500 MHz
- 50 Ω Source and Load
- Surface Mount
- Also available with SMA connectors

Typical Performance

Overall Response (10 dB/div)



Typical Performance

Passband Amplitude & Group Delay (1 dB/div & 10 nsec/div)

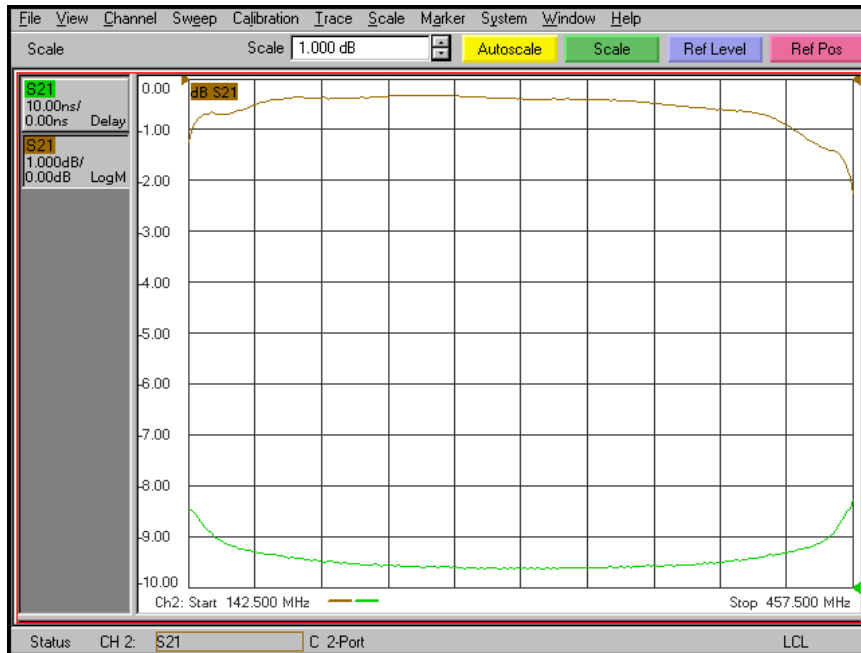

Overall Response (10 dB/div)

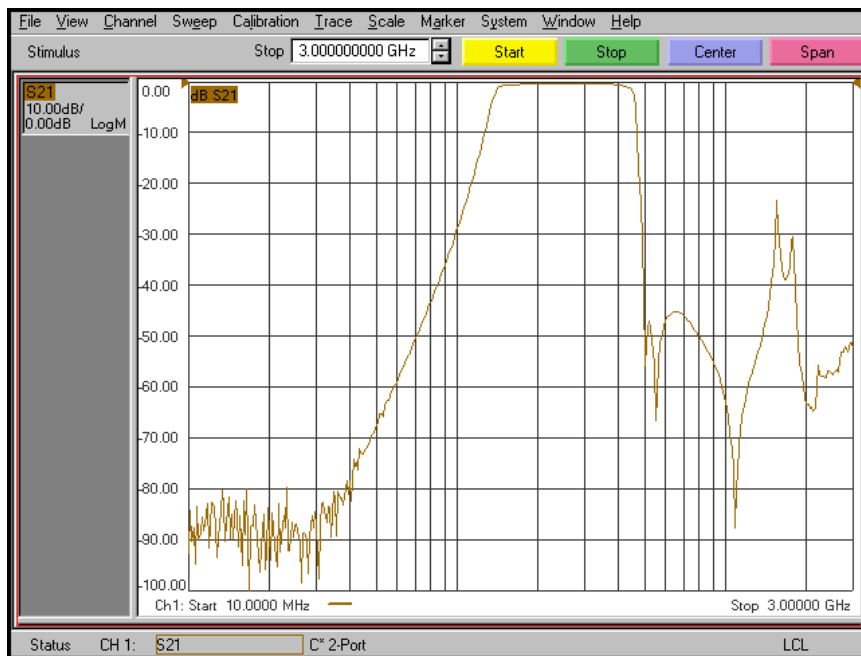

KR Electronics, Inc.
91 Avenel Street
Avenel, NJ 07001

Web www.krfilters.com
Email sales@krfilters.com
Phone (732) 636-1900
Fax (732) 636-1982

KR Electronics, Inc. 3112

Specifications

Parameter	Specification	Notes
Filter type	Bandpass	
Center Frequency	300 MHz	
Insertion Loss at 375 MHz	1 dB max	0.5 dB typical
3 dB Bandwidth	315 MHz min	
Rejection at 50 MHz	40 dB min	
Rejection at 500 MHz to 1000 MHz	40 dB min	
Source and Load	50 Ω	

Physical Dimensions

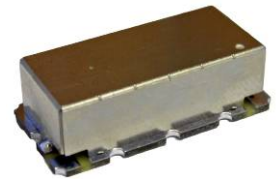
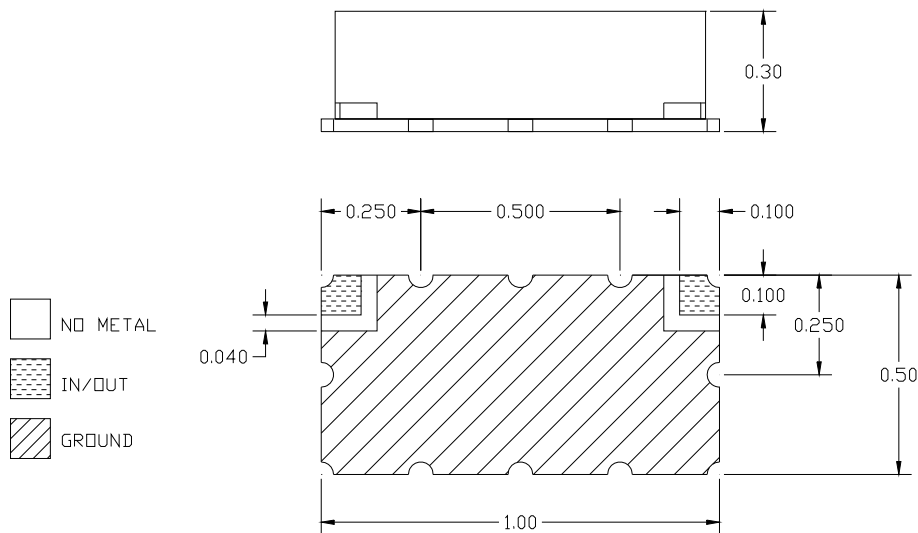

Notes:

1. Surface mount package — Metal cover
2. Dimensions in inches
3. Maximum reflow temperature is 230° C for 10 sec maximum.
4. If boards are cleaned after installation, dry units completely.

KR Electronics, Inc.
91 Avenel Street
Avenel, NJ 07001

Web www.krfilters.com
Email sales@krfilters.com
Phone (732) 636-1900
Fax (732) 636-1982