

KR Electronics, Inc.

General Description

KR Electronics part number 2954 is a 1210 MHz bandpass filter. The filter has a minimum 1 dB bandwidth of 380 MHz. Other center frequencies and bandwidths available. Please consult the factory.

Features

- 1210 MHz Center Frequency
- 1020 MHz to 1400 MHz Passband
- 50 Ω Source and Load
- Surface Mount

Typical Performance

Overall Response (10 dB/div)



KR Electronics, Inc.
91 Avenel Street
Avenel, NJ 07001

Web www.krfilters.com
Email sales@krfilters.com
Phone (732) 636-1900
Fax (732) 636-1982

Typical Performance

Passband Amplitude & Group Delay (1 dB/div & 1 nsec/div)

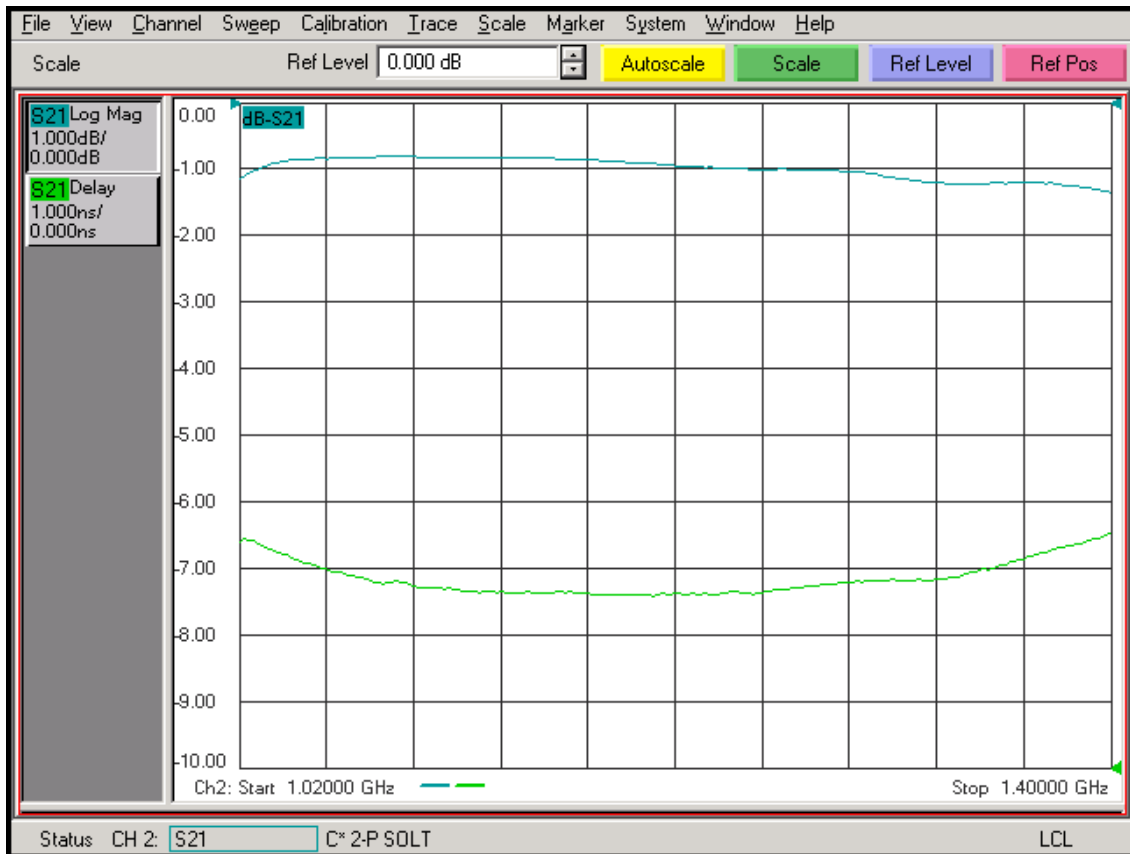

KR Electronics 2954

Specifications

Parameter	Specification	
Filter type	Bandpass	
Center Frequency	1210 MHz	
Insertion Loss	2 dB max	1 dB typical
1 dB Bandwidth	380 MHz min	437 MHz typical
3 dB Bandwidth	507 MHz typical	
20 dB Bandwidth	755 MHz typical	
40 dB Bandwidth	1215 MHz typical	
Source and Load	50 Ω	

Physical Dimensions

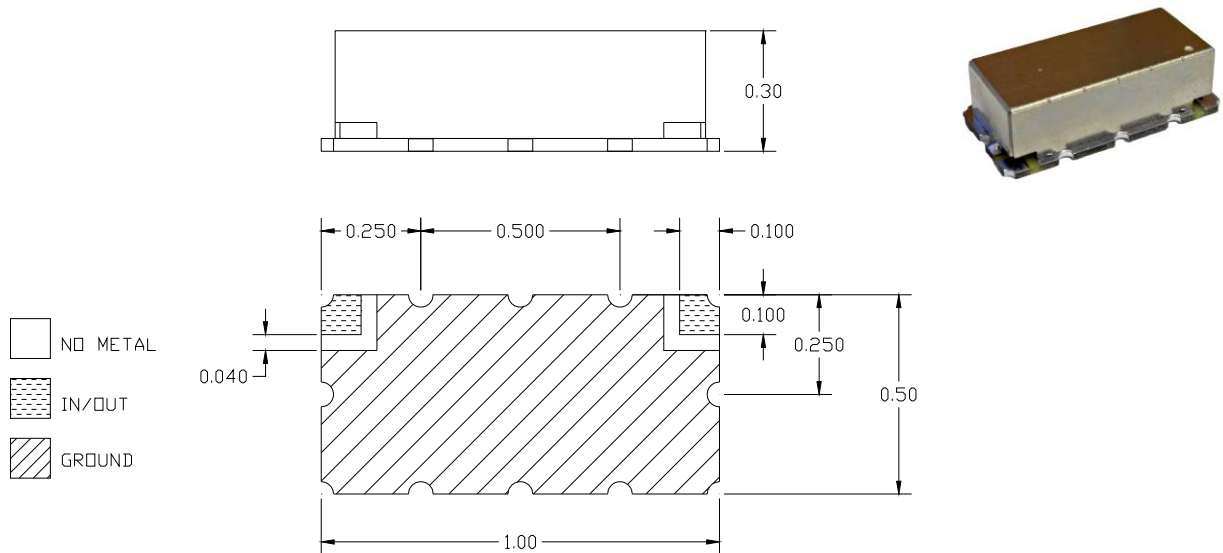

Notes:

1. Surface mount package
2. Dimensions in inches
3. Max reflow temperature 209° C for 10 sec
4. If boards are cleaned after installation units must be completely dried

KR Electronics, Inc.
91 Avenel Street
Avenel, NJ 07001

Web www.krfilters.com
Email sales@krfilters.com
Phone (732) 636-1900
Fax (732) 636-1982